

WAREHOUSE / DISTRIBUTION CENTER

7 A STREET

Hyde Park, Massachusetts

FOR LEASE

1,442 SF / 1,264 SF AVAILABLE



BUILDING SPECIFICATIONS

- Building Size:

+/- 5,590 SF
- Available Space:

1,442 SF & 1,264 SF
TOTAL: 2,706 SF
- Property Type:

Warehouse / Distribution Center
- Parking:

Surface parking available
- Zoning:

Hyde Park Neighborhood
- Zoning Subdistrict:

Local Industrial 1 (LI – 1)
- Permitted Uses:

Warehousing, General & Light Manufacturing, Clinic & Clinical Laboratory, Educational Facility, Community Uses, and Research & Product Development. Vehicle uses prohibited.



FLOOR 1: 2,706 SF

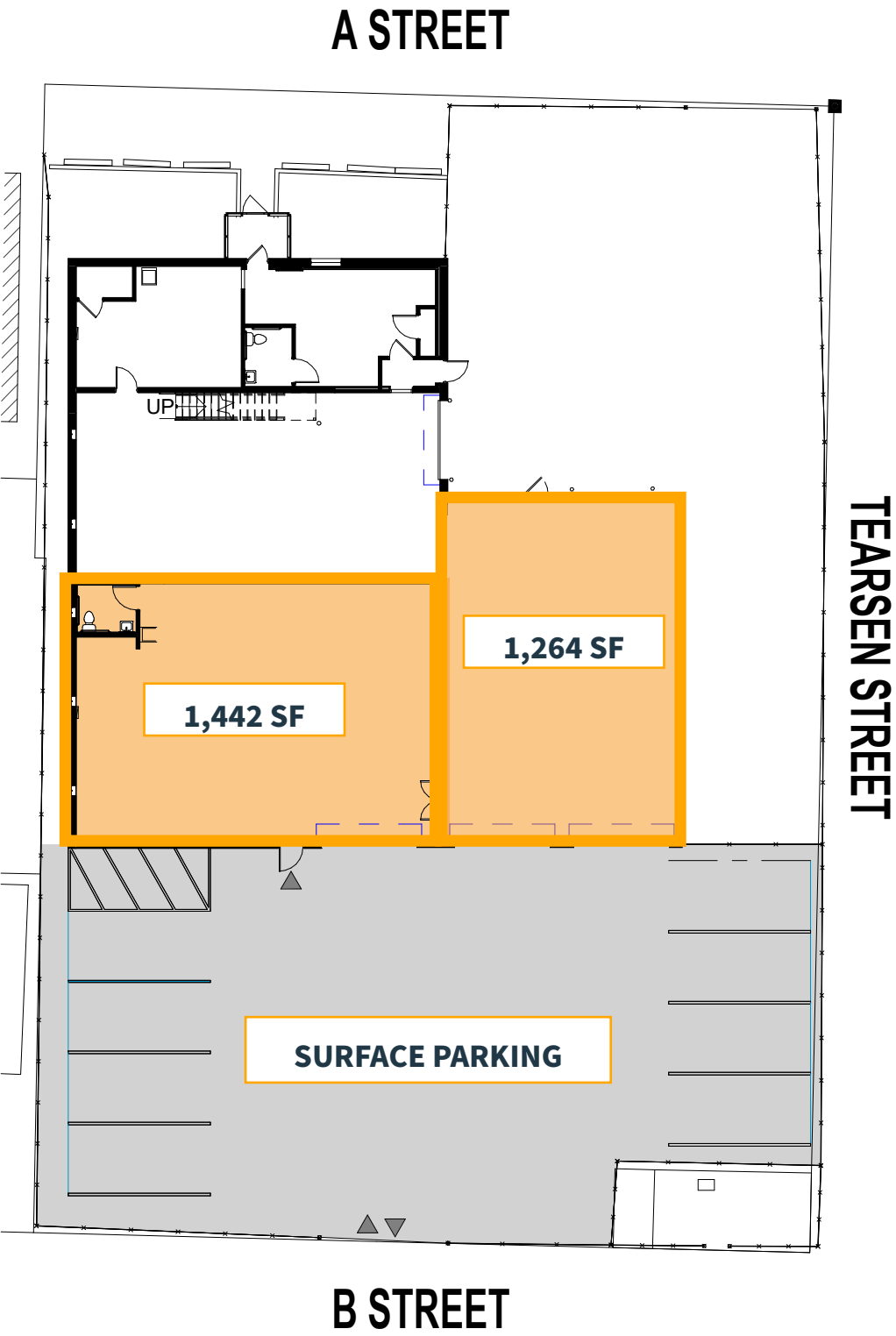

SPACE AVAILABLE FOR LEASE

7 A STREET

Hyde Park, Massachusetts



ACCESS



0.4 miles to
Hyde Park Station



0.6 miles to
Fairmount Station



10 min drive
to I-93



10 min drive
to I-95



25 min drive to
downtown Boston

CONTACT US TO ARRANGE A TOUR

PETER BEAN

781.771.7715

pbean@hunneanre.com



303 Congress Street, Boston, MA 02210 | 617.457.3400 | www.hunneanre.com

©2023 Hunnean. All rights reserved. All information has been obtained from sources believed reliable but no warranty or representation is verified for accuracy or completeness. Caution and independent investigation of property and information should be verified. Reliance on this information is at your own risk.